

# XPression

## Getting Started

⚠ CAUTION: Before you set up and operate this product, see the “Important Safety Instructions” in your Manual.

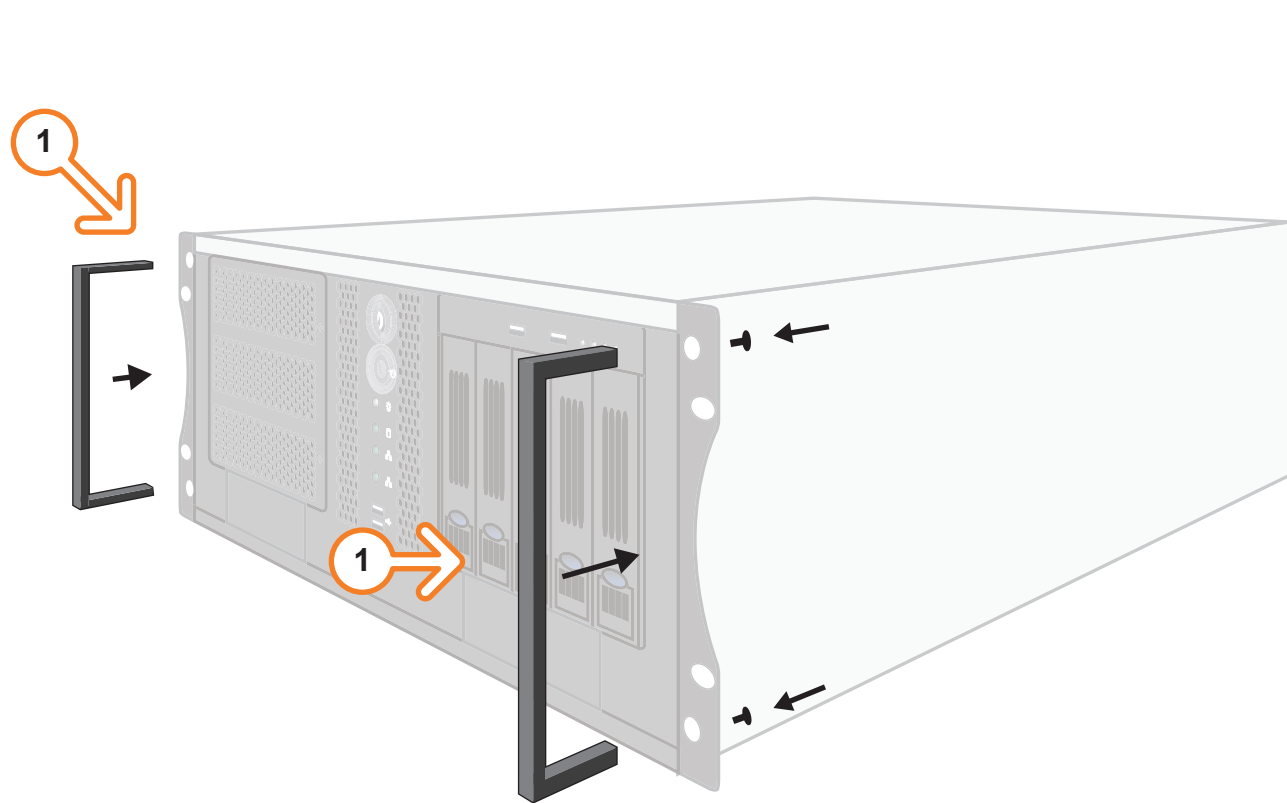

- 1 Attach the handles to the front rack-mount tabs by aligning the handle with the round holes and fastening from the rear with the supplied screws.
- 2 Use the supplied Rack Mount Kit to mount the XPression system in a 19" EIA equipment rack.  
*For information on installing the XPression chassis in a rack, see the provided document “Installing the Chassis in a Rack”.*
- 3 Plug the supplied Keyboard into a **USB** port.
- 4 Plug the supplied Mouse into a **USB** port.
- 5 Connect a Monitor (customer supplied) to any of the four display ports.  
*KVM extenders (customer supplied) are required when the XPression system monitor, keyboard, and mouse are located remotely from the rack room.*
- 6 Plug an Ethernet cable from your Local Area Network into one of the **Ethernet** ports.  
*XPression systems can run standalone or accept a connection to a production network. The network connection is also used for the RossTalk / Smart GPI Feature.*
- 7 Connect your house reference Genlock signal to the **REF** HD-BNC connector.  
*XPression systems accept analog blackburst or tri-level sync as reference inputs. Tri-level sync is recommended for HD installations.*

When contacting technical support, please provide the information listed on this label.

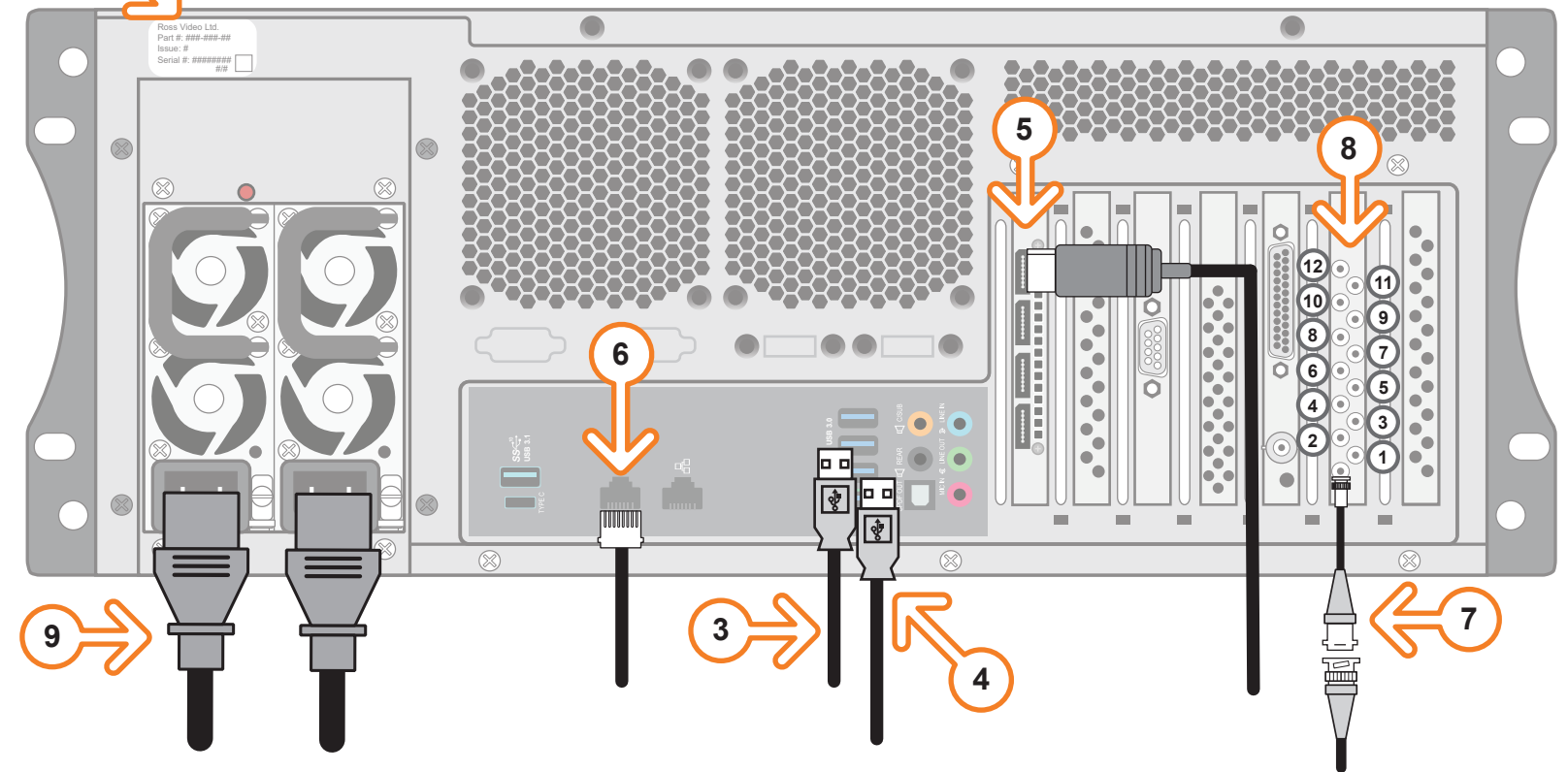

- 8 Connect the HD-BNC end of the pigtail cables to the HD-BNC connectors and attach the SDI cables to the BNC end of the pigtails according to their required destination (see the *XPression User Guide* or Help file for information about configuring the key and fill for the HD-BNC connectors).  
See page 2 for configuration instructions.  
*Not all HD-BNC connectors will be active depending on the XPression software edition. Keep any unused pigtail and SDI cables in a safe place for future use.*  
*If your facility requires analog outputs, additional outboard digital to analog conversion equipment is available from Ross Video.*  
*Inputs/outputs can be configured in the Hardware Setup in the XPression User Guide or Help file.*
- 9 Connect power cords from the **AC** Ports on the XPression system to the mains power.  
*XPression system power supplies are auto-sensing and can use either 110 VAC or 220 VAC.*

*Continued on other side...*

Getting Started continued

To launch XPression:

- 1 Press the **Power** button (⏻) on the front of the XPression system.  
*Ross Video recommends shutting down XPression systems from the Windows operating system.*
- 2 Click the XPression user account icon on the desktop.
- 3 Log onto the system.
- 4 Launch XPression from the **Start** menu.

To configure the XMIO5:

- 1 Stop all applications using the Matrox card and ensure that the card is installed.
- 2 Run the machine as administrator:
- 3 Click the **Windows Start** button.
- 4 Type *Command Prompt*.
- 5 Right-click on **Command Prompt** and select **Run as administrator**.
- 6 In the **Command Prompt**, type the following to get to the directory:  
`cd C:\Program Files\Matrox DSX-TopologyUtils\drivers`
- 7 Then type:  
`mvConnectorConfig.exe load-f=Xmio5Le5ConnectorMapping\Xmio5\Pinout_XiYo.pin -sn=XXXXXXXX`

a

b

  - a. Replace **Pinout\_XiYo.pin** with **.pin** file you want to use. For example **xmio5\_x2\_06i06o.pin** provides 6 inputs and 6 outputs.
  - b. Replace the **XXXXXXXX** with the serial number of the Matrox card.  
To find the serial number, open the **Matrox X.info** app from the Windows system tray, select **Hardware** from the drop-down and look at the hardware information.  
The final **mvConnectorConfig** should look something like this:  
`C:\Program Files\Matrox DSX-TopologyUtils\drivers>mvConnectorConfig.exe load-f=Xmio5Le5ConnectorMapping\Xmio5\Pinout_06i06o.pin -sn=A572788`
- 8 Reboot the machine.
- 9 In XPression, click **Edit > Hardware Setup** and select the **Inputs/Outputs** tab to confirm the video I/O settings.

For information on...

- operating XPression, see the “XPression User Guide” available in the C:\Archive folder
- maintenance of the XPression system, see the “XPression Maintenance Guide” in the C:\Archive folder
- other XPression features and functions, see the documents available in the C:\Archive folder

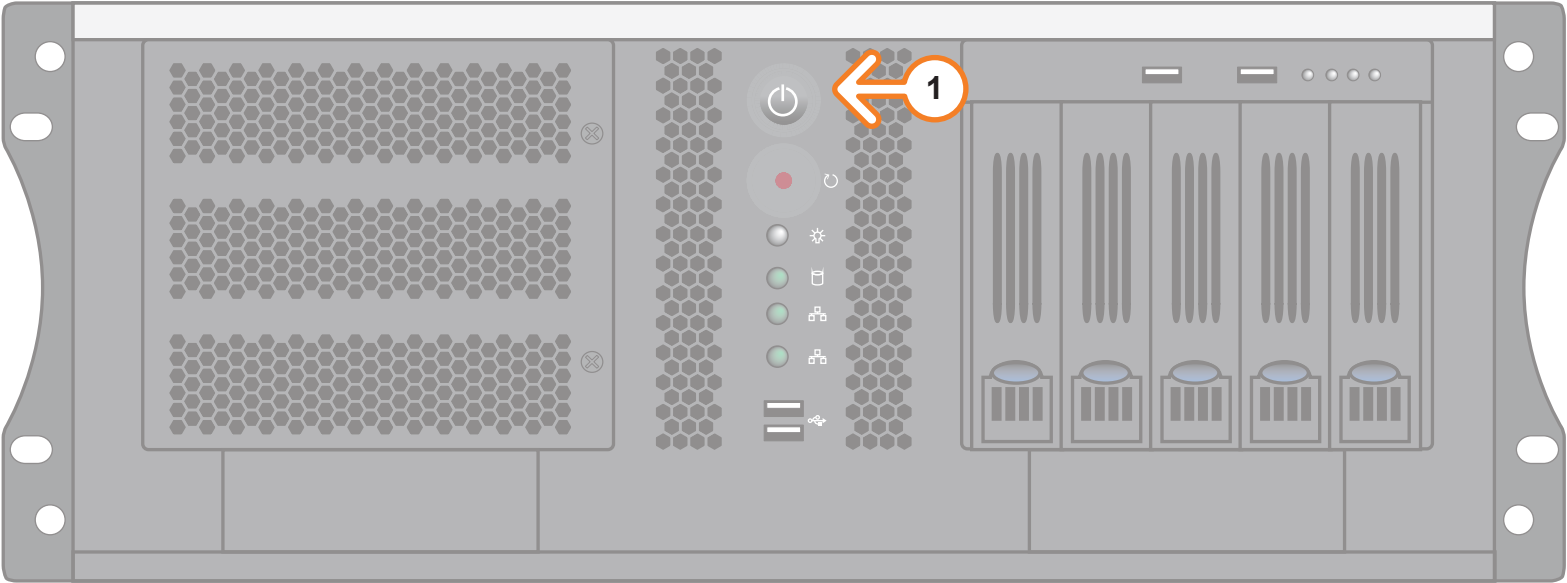

HD-BNC	Default (6 in, 6 out)	10 In, 2 Out	4 In, 8 Out	8 In, 4 Out
1	In 1*	In 1*	In 1*	In 1*
2	In 2*	In 2*	In 2*	In 2*
3	In 3*	In 3*	In 3*	In 3*
4	In 4*	In 4*	In 4*	In 4*
5	In 5^	In 5^	Out 1^	In 5^
6	In 6^	In 6^	Out 2^	In 6^
7	Out 1^	In 7^	Out 3^	In 7^
8	Out 2^	In 8^	Out 4^	In 8^
9	Out 3*	In 9*	Out 5*	Out 1*
10	Out 4*	In 10*	Out 6*	Out 2*
11	Out 5*	Out 1*	Out 7*	Out 3*
12	Out 6*	Out 2*	Out 8*	Out 4*

\*Up to 12G  
^Up to 3G



Need Help?

Technical Support:  
1-844-652-0645 (North America)  
+800 1005 0100 (International)  
Email: techsupport@rossvideo.com

